

# INTERNAL GEAR TOOTH MICROMETERS

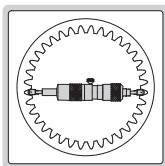

cylindrical tips (optional)



before ball tips  
are installed



ball tips  
are optional



ball tips  
are optional

3638-200

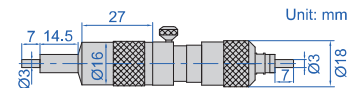

micrometer head (100-115mm)

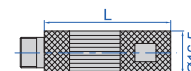

extension rod

- Measure over-pin diameter of gears
- Points of extension rods are spring loaded
- Optional accessory: ball tips (code **7383**), cylindrical tips (code **7393**)

### Micrometer head

Range	Graduation	Accuracy
100-115mm	0.01mm	±4µm
150-175mm	0.01mm	±4µm

### Extension rod

Length (L)	Accuracy
15mm	±1µm
25mm	±1.25µm
30mm	±1.25µm
50mm	±1.25µm
100mm	±2µm
200mm	±3.5µm
400mm	±4.5µm

Code	Range	Micrometer head	Extension rod (L)
3638-200*	100-205mm	100-115mm	15mm, 25mm, 50mm
3638-500*	100-505mm	100-115mm	15mm, 25mm, 50mm, 100mm, 200mm
3638-900*	100-905mm	100-115mm	15mm, 25mm, 50mm, 100mm, 200mm, 400mm
3638-1100*	150-1150mm	150-175mm	25mm, 50mm, 100mm, 200mm, 200mm, 400mm

\*Supplied with manufacturer inspection certificate